

InvisiPac™ HM25 Tank-Free™

Mounting Adapter Plate Kit

407070C

EN

For installing InvisiPac in place of an existing hot melt applicator system. For professional use only.

Not approved for use in explosive atmospheres or hazardous locations.



Important Safety Instructions

Read all warnings and instructions in InvisiPac system manual 3A2347. Save all instructions.

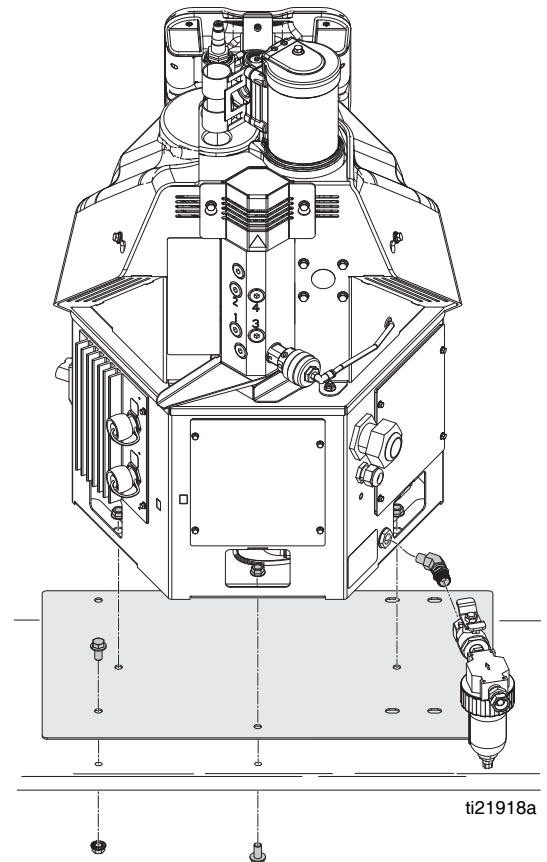

Parts

Bolt Hole Dimensions

- A 9.8 in. (249 mm)
- B 14.843-15.157 in. (377.0-385.0 mm)
- C 17.003-17.317 in. (431.9-439.9 mm)
- D 23.0 in. (584.2 mm)
- E 13.0 in. (330.2 mm)

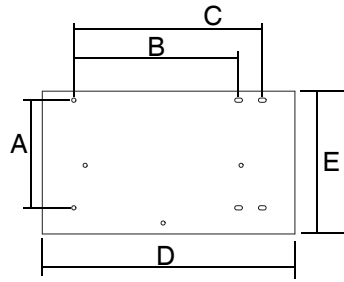
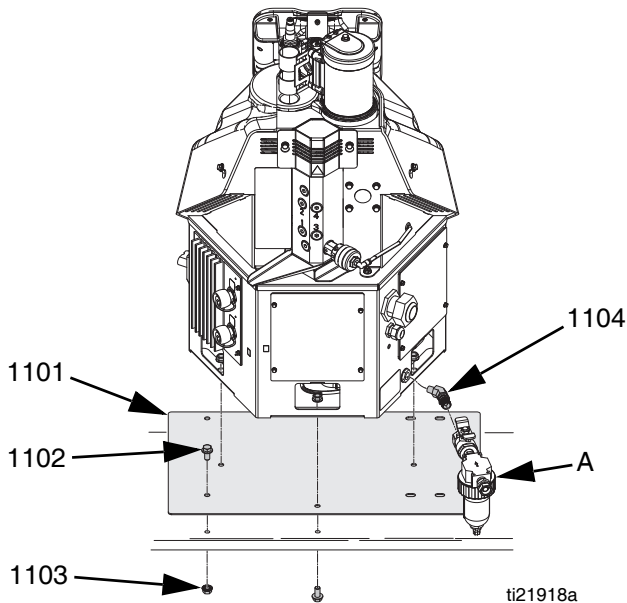
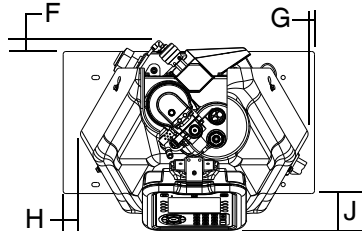

Plate Extension Dimensions

- F 0.99 in. (25.1 mm)
- G 0.58 in. (14.7 mm)
- H 1.58 in. (40.1 mm)
- J 3.36 in. (85.3 mm)



Installation

1. Remove existing hot melt applicator system.
2. Use six screws (1102) and six nuts (1103) to secure adapter plate (1101) through the existing holes from the previous system.
3. Align the InvisiPac system with the bolts on the adapter plate (1101) then place onto the adapter plate (1101).
4. Use the remaining three nuts (1103) to secure the InvisiPac system to the adapter plate (1101).
5. Use elbow fitting (1104) to install system air inlet filter (A, not included with kit).

Ref	Part	Description	Qty
1101	---	PLATE, adapter	1
1102	112395	SCREW flange head cap	6
1103	112958	NUT, hex, flanged	9
1104	121283	FITTING, elbow, 45 degree	1

Graco Information

Sealant and Adhesive Dispensing Equipment

For the latest information about Graco products, visit www.graco.com.

For patent information, see www.graco.com/patents.

TO PLACE AN ORDER, contact your Graco distributor, go to www.graco.com and select "Where to Buy" in the top blue bar, or call to find the nearest distributor.

If calling from the US: 800-746-1334

If calling from outside the US: 0-1-330-966-3000

All written and visual data contained in this document reflects the latest product information available at the time of publication. Graco reserves the right to make changes at any time without notice.

Original instructions. This manual contains English. MM 407070

Graco Headquarters: Minneapolis
International Offices: Belgium, China, Japan, Korea

GRACO INC. AND SUBSIDIARIES • P.O. BOX 1441 • MINNEAPOLIS MN 55440-1441 • USA

Copyright 2013, Graco Inc. All Graco manufacturing locations are registered to ISO 9001.

www.graco.com

Revision C, January 2017